

# Panel Replacement Procedure

Page 1 of 3

The Strukturoc wall panels can be replaced without removing the entire wall. One panel or more can easily be replaced when simply following these steps below.

## Recommended Tools:

- 1) Cotton work gloves or clean gloves.
- 2) Safety Glasses.
- 3) Corded or Cordless Metal Cutting Shears or Circular Saw.
- 4) Corded or Cordless 4 ½" grinder with cut off wheel.
- 5) Metal Cutting Hand Shears.
- 6) Tape Measure
- 7) Rivet Gun
- 8) 1/16" and 3/8" drill bits.
- 9) Screw Gun

# Panel Replacement Procedure

The Strukturoc wall panels can be replaced without removing the entire wall. One panel or more can easily be replaced when simply following these steps below.

**\*\*NOTE\*\* Careful planning and preparation must be taken when replacing the panel by protecting the adjacent panels from the hot metal shavings and scarring from the metal cutting shears or circular saw when cutting the panel. The use of plywood sheathing to protect the surface of the non damaged panel is recommended.**

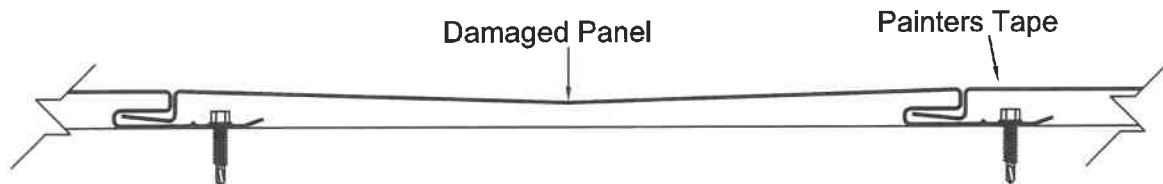

Use painter's tape to protect along the left edge of the panel directly right of the damaged panel.

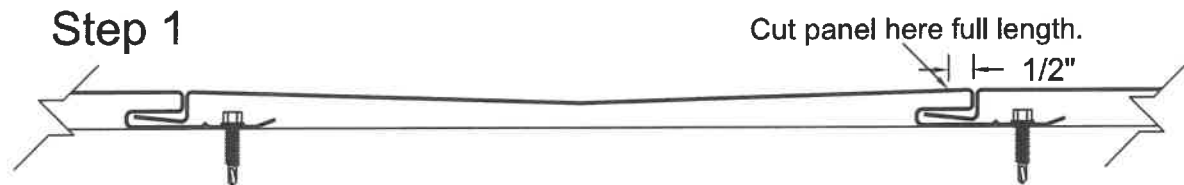

Option 1: Using the 1/16" drill bit make a pilot hole on the right side of the damaged panel approx.  $\frac{1}{2}$ " from the edge of the panel. Use the 3/8" drill bit to expand the pilot hole so a metal cutting shear and cut the entire height of the damaged panel. Using the hand metal shears cut the factory tab at the top and bottom of the panel and remove the damaged panel.

Option 2: Cut panel approx.  $\frac{1}{2}$ " from the right edge from bottom to top. Remove as much of the panel possible and protect the surface of the adjacent panel from hot metal shavings and scarring from the Metal Cutting Shears, 4  $\frac{1}{2}$ " Cutting Wheel or Circular Saw.

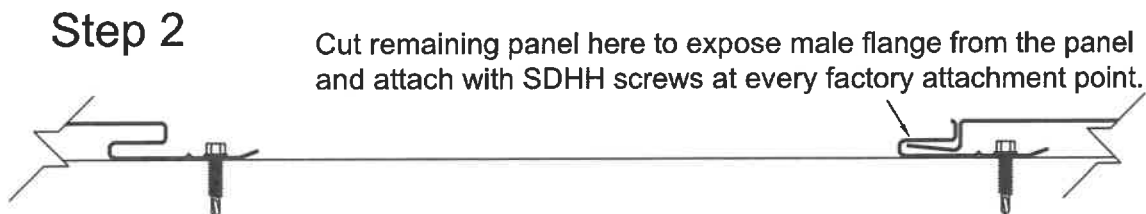

Using either a grinder with cut off wheel, metal shears or a circular saw remove the remaining metal from the damaged panel and secure the panel flange to the building using SDHH screws.

# Panel Replacement Procedure

The Strukturoc wall panels can be replaced without removing the entire wall. One panel or more can easily be replaced when simply following these steps below.

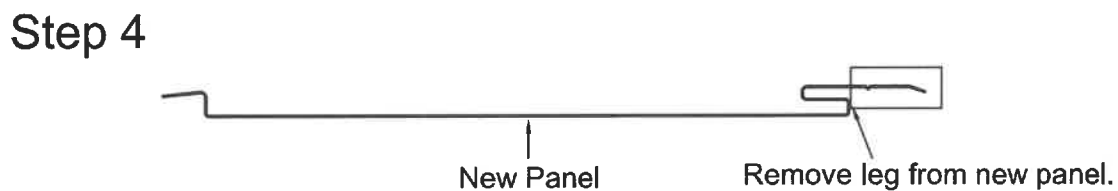
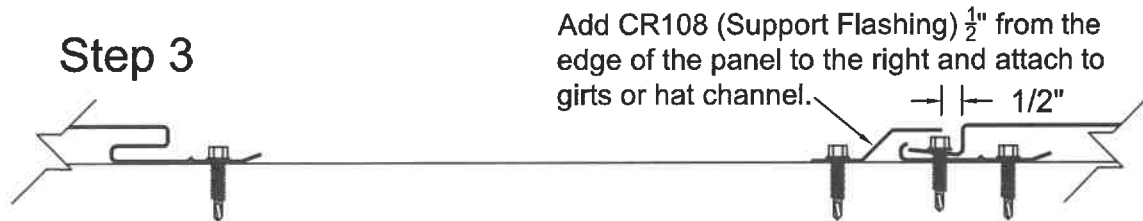

Using some towels or a blanket to protect the finished surface of the panel. Turn over the new panel and remove the tab in the area shown in the window.

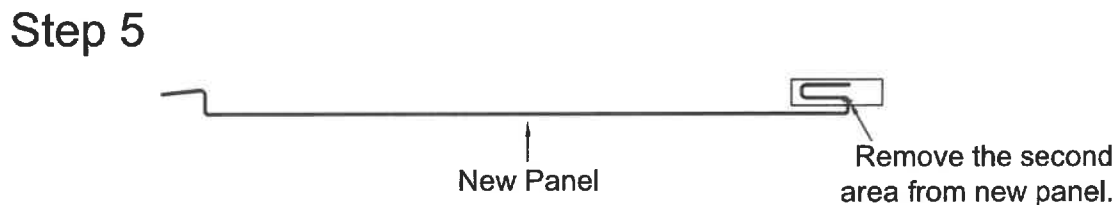

Using the  $\frac{1}{16}$ " drill bit make a pilot hole off center from the face of the panel. Use the  $\frac{3}{8}$ " drill bit to enlarge the pilot hole so a metal cutting shear can cut the entire length of the new panel. Using the hand metal shears cut the remaining metal at the top and bottom of the panel.

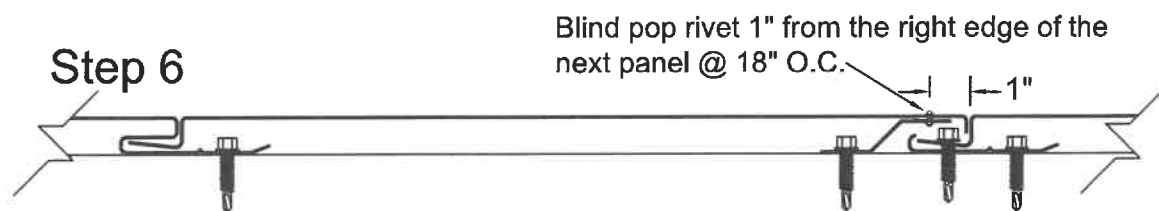

Install new panel inserting the left edge into the remaining tab and rotating down to the support flashing (CR108). Use blind pop rivets to attach the panel to the CR108 at 18" on center and cover the head of the pop rivets with the matching textured touch-up paint.